

NOTICE!!

These documents have been scanned!

Do not place un-scanned documents beneath this notice!

Do not remove this notice from this file!

GPO Jacket No. 560-102
Print Order 61540
Rise Business Services, LLC
Job=AZ15 5/6/2019



Box Number= AZ15020



Claim Begin-End: AMC436649-AMC436649

1 Initial Receipt



AZ15020-18

AMC435945-AMC436659

United States Department of the Interior
Bureau of Land Management
LANDS/RECREATION & PLANNING
ONE N CENTRAL AVE
PHOENIX, AZ 85004 -2203
Phone: 602-417-9200

Receipt

No: 3487365

Transaction #: 3587618	
Date of Transaction: 02/04/2016	
CUSTOMER:	
DWAYNE FARMER PO BOX 5335 QUARTZSITE, AZ 85359-5335 US	

ENTERED
FEB 09 2016
BY: *RAM*

LINE #	QTY	DESCRIPTION	REMARKS	UNIT PRICE	TOTAL
1	1.00	LOCATABLE MINERALS / MINING CLAIMS-NEW, UNADJUD, ONE OR MORE AUTH NOS / NEW MINING CLAIMS LOCATION FEE CASES: AMC436649/\$37.00		- n/a -	37.00
2	1.00	LOCATABLE MINERALS / MINING CLAIMS-NEW, UNADJUD, ONE OR MORE AUTH NOS / NEW MINING CLAIM PROCESSING FEE CASES: AMC436649/\$20.00		- n/a -	20.00
3	1.00	LOCATABLE MINERALS / MINING CLAIMS-NEW, UNADJUD, ONE OR MORE AUTH NOS / NEW MINING CLAIMS MAINTENANCE FEE CASES: AMC436649/\$155.00		- n/a -	155.00
4	1.00	LOCATABLE MINERALS / MINING CLAIMS-NOT NEW-UNADJUD, ONE AUTH NO. ONLY / MINING CLAIM MONEY RECEIVED CASES: AMC436649/\$155.00	NEW ASSOC PLACER	- n/a -	155.00
5	1.00	OVERPAYMENT / OVERPAYMENT OF FEES / OVERPAYMENT OF \$1.00 OR MORE		11.00	11.00
TOTAL:					\$378.00

PAYMENT INFORMATION				
1	AMOUNT:	378.00	POSTMARKED:	01/29/2016
	TYPE:	CHECK	RECEIVED:	02/03/2016
	CHECK NO:	3100		
	NAME:	FARMER, DWAYNE PO BOX 5335 QUARTZSITE AZ 85359-5335 US		

REMARKS

This receipt was generated by the automated BLM Collections and Billing System and is a paper representation of a portion of the official electronic record contained therein.

NOTICE!!

These documents have been scanned!

Do not place un-scanned documents beneath this notice!

Do not remove this notice from this file!

GPO Jacket No. 560-102
Print Order 61540
Rise Business Services, LLC
Job=AZ15 5/6/2019



Box Number= AZ15020



Claim Begin-End: AMC436649-AMC436649

2 Correspondence



AZ15020-18

AMC435945-AMC436659



United States Department of the Interior



BUREAU OF LAND MANAGEMENT
Arizona State Office
One North Central Avenue, Suite 800
Phoenix, Arizona 85004-4427
www.blm.gov/az/

JUL 25 2016

In Reply Refer To:
3800 (9200) RM
AMC427687, AMC436649

CERTIFIED MAIL – RETURN RECEIPT REQUESTED NO. 7015 1660 0000 0271 7924

NOTICE

NUGGET WRANGLERS ASSOCIATION	:	This Notice Affects Those Claims
PO BOX 5335	:	Shown in the Block Below.
QUARTZSITE, AZ 85359-5335	:	

AMC427687, AMC436649
HIDDEN TREASURE, BIG WASH

Transfer of Association Placer Mining Claims Amendments or Discovery Documentation Required

The Bureau of Land Management (BLM) Arizona State Office received a conveyance document transferring ownership of the above listed mining claims.

The mining claims being transferred are association placer mining claims. The claims are being transferred to a smaller number of claimants than originally located the claims.

By law, each individual claimant is allowed to hold a maximum of 20 acres per claim. A corporation is considered to be a single entity that is allowed to hold a maximum of 20 acres per claim. In accordance with 43 CFR 3833.33, you may transfer, sell, or otherwise convey an association placer mining claim at any time to an EQUAL or greater number of mining claimants. However, if the claim is transferred to a smaller number of claimants you (a) must have discovered a valuable mineral deposit before the transfer; or (b) upon notice from BLM, you must reduce the acreage of the claim, if necessary, so that you meet the 20-acre per locator limit.

The BLM is therefore requiring that an amendment be filed for each claim listed above, in accordance with 43 CFR 3833.33, reducing the claims acreage to meet the 20-acre per claimant limit, as is authorized by law; or submit appropriate documentation supporting that there was a discovery of a valuable mineral deposit prior to the date of transfer. We are enclosing a guide to

clarify what documentation must be provided to BLM to support a discovery of a valuable mineral deposit. The documentation will be reviewed by a mineral examiner to determine if the submitted documents are sufficient.

We must receive either the amendments or documentation of discovery of a valuable mineral deposit within 30 days of your receipt of this notice. If the amendments or the required documentation are not received within the 30-day timeframe the mining claims will be declared forfeited and void. If amendments are filed, there is a \$10 BLM processing fee for each amendment. The amendments must also be filed with the county.

If additional information is required, please contact RéAnn Myers at 602-417-9413. Please include your AMC serial number(s) on all correspondence.



Rebecca Heick
Deputy State Director
Lands, Minerals and Energy Division

Enclosure

SENDER: COMPLETE THIS SECTION

- Complete items 1, 2, and 3.
- Print your name and address on the reverse so that we can return the card to you.
- Attach this card to the back of the mailpiece, or on the front if space permits.

1. Article Addressed to:

NUGGET WRANGLERS ASSOCIATION
 PO BOX 5335
 QUARTZSITE AZ 85359-5335
 920/RM/AMC427687, AMC436649



9590 9402 1831 6104 4740 10

2. Article Number (Transfer from service label)

7015 1660 0000 0271 7924

COMPLETE THIS SECTION ON DELIVERY

A. Signature

X: *[Signature]* Agent
 Addressee

B. Received by (Printed Name)

C. Date of Delivery

D. Is delivery address different from item 1? Yes
 If YES, enter delivery address below: No

3. Service Type

- | | |
|--|---|
| <input type="checkbox"/> Adult Signature | <input type="checkbox"/> Priority Mail Express® |
| <input type="checkbox"/> Adult Signature Restricted Delivery | <input type="checkbox"/> Registered Mail™ |
| <input checked="" type="checkbox"/> Certified Mail® | <input type="checkbox"/> Registered Mail Restricted Delivery |
| <input type="checkbox"/> Certified Mail Restricted Delivery | <input checked="" type="checkbox"/> Return Receipt for Merchandise |
| <input type="checkbox"/> Collect on Delivery | <input checked="" type="checkbox"/> Signature Confirmation™ |
| <input type="checkbox"/> Collect on Delivery Restricted Delivery | <input type="checkbox"/> Signature Confirmation Restricted Delivery |
| <input type="checkbox"/> Mail | |
| <input type="checkbox"/> Mail Restricted Delivery (500) | |

PS Form 3811, July 2015 PSN 7530-02-000-9053

Domestic Return Receipt

USPS TRACKING#



9590 9402 1831 6104 4740 10

First-Class Mail
 Postage & Fees Paid
 USPS
 Permit No. G-10

United States Postal Service

Sender: Please print your name, address, and ZIP+4® in this box*

UNITED STATES
 DEPARTMENT OF THE INTERIOR
 Bureau of Land Management
 Arizona State Office
 100 N. Central Avenue, Suite 800
 Phoenix, AZ 85004-4427

BLM RECEIVED
 2016 AUG -2 PM 2:12
 PHOENIX, ARIZONA

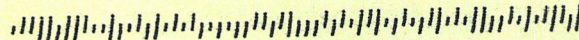



United States Department of the Interior



BUREAU OF LAND MANAGEMENT

Arizona State Office

One North Central Avenue, Suite 800

Phoenix, Arizona 85004-4427

www.blm.gov/az/

JUL 25 2016

RECEIVED
BLM AZ STATE OFFICE
2016 AUG -2 A 8:36
PHOENIX, ARIZONA

In Reply Refer To:
3800 (9200) RM
AMC427687, AMC436649

CERTIFIED MAIL – RETURN RECEIPT REQUESTED NO. 7015 1660 0000 0271 7924

NOTICE

NUGGET WRANGLERS ASSOCIATION	:	This Notice Affects Those Claims
PO BOX 5335	:	Shown in the Block Below.
QUARTZSITE, AZ 85359-5335	:	

AMC427687, AMC436649
HIDDEN TREASURE, BIG WASH

Transfer of Association Placer Mining Claims
Amendments or Discovery Documentation Required

The Bureau of Land Management (BLM) Arizona State Office received a conveyance document transferring ownership of the above listed mining claims.

The mining claims being transferred are association placer mining claims. The claims are being transferred to a smaller number of claimants than originally located the claims.

By law, each individual claimant is allowed to hold a maximum of 20 acres per claim. A corporation is considered to be a single entity that is allowed to hold a maximum of 20 acres per claim. In accordance with 43 CFR 3833.33, you may transfer, sell, or otherwise convey an association placer mining claim at any time to an EQUAL or greater number of mining claimants. However, if the claim is transferred to a smaller number of claimants you (a) must have discovered a valuable mineral deposit before the transfer; or (b) upon notice from BLM, you must reduce the acreage of the claim, if necessary, so that you meet the 20-acre per locator limit.

The BLM is therefore requiring that an amendment be filed for each claim listed above, in accordance with 43 CFR 3833.33, reducing the claims acreage to meet the 20-acre per claimant limit, as is authorized by law; or submit appropriate documentation supporting that there was a discovery of a valuable mineral deposit prior to the date of transfer. We are enclosing a guide to

*SPOKE WITH MR. FARMER ON
8/8/2016. DISCUSSED AMENDING
TO 20 ACRES AND LOCATING 2
NEW 20 ACRE CLAIMS. RM*

clarify what documentation must be provided to BLM to support a discovery of a valuable mineral deposit. The documentation will be reviewed by a mineral examiner to determine if the submitted documents are sufficient.

We must receive either the amendments or documentation of discovery of a valuable mineral deposit within 30 days of your receipt of this notice. If the amendments or the required documentation are not received within the 30-day timeframe the mining claims will be declared forfeited and void. If amendments are filed, there is a \$10 BLM processing fee for each amendment. The amendments must also be filed with the county.

If additional information is required, please contact RéAnn Myers at 602-417-9413. Please include your AMC serial number(s) on all correspondence.

Rebecca Heick

Rebecca Heick
Deputy State Director
Lands, Minerals and Energy Division

Enclosure

RECEIVED
BLM AZ STATE OFFICE
2016 AUG -2 A 8:38
PHOENIX, ARIZONA

*Nugget Wranglers ASSOC.
AT least 30 members*

*Claims Not ASSOC. Claims
Private Claims Dwayne Farmer
Joyce Farmer*

Did we get things turned around?

QUIT CLAIM DEED

The undersigned grantor(s), for valuable consideration, receipt of which is hereby acknowledged, in the amount of \$10.00, or other values, do we hereby remise, release and forever quit claim to the following described property in the county of La Paz state of AZ Mining claim known as Big Wash in Township 4 N Range 20 W Section 11, 13, 13, 14 Quarter Section(s) _____ AMC # 436649
To: Nugget Wranglers Assoc.
Address: Box 5335 Quartzsite AZ, 85359

NW 1/4 of NW 1/4 Sec. 11
NE 1/4 of NE 1/4 Sec. 12
SW 1/4 of SW 1/4 Sec. 14

*EXEMPTTARS 11:1134

SE 1/4 of SE 1/4 Sec 13

Owner(s) Name(s)

Signature(s)

Dwayne Farmer

Joyce Farmer

Dwayne Farmer

Joyce Farmer

RECEIVED
BEM AZ STATE OFFICE
2016 AUG - 22 A 8 39
PHOENIX, ARIZONA

The Undersigned, a notary public in and for said State, in person and all signing said document. Dated this 27 date of May 2016.

Witness my hand and official seal.

Amy K Lopresti

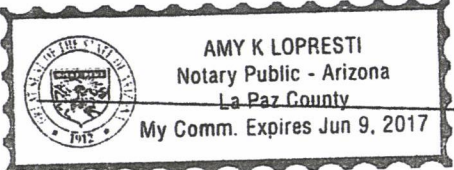

copy

QUIT CLAIM DEED

The undersigned grantor(s), for valuable consideration, receipt of which is hereby acknowledged, in the amount of \$10.00, or other values, do we hereby remise, release and forever quit claim to the following described property in the county of La Paz state of AZ Mining claim known as Hidden Treasure in Township 4 N Range 20 W Section 17 Quarter Section(s) NE 1/4, SE 1/4, NW 1/4 AMC # 427687
To: Nugget Wranglers Assoc.
Address: Box 5335 Quartzsite AZ 85354

*EXEMPTTARS 11:1134

Owner(s) Name(s)

Signature(s)

Dwight Farmer
Joyce Farmer

Dwight Farmer
Joyce Farmer

RECEIVED
BLM AZ STATE OFFICE
2010 AUG -2 A 8:39
PHOENIX, ARIZONA

The Undersigned, a notary public in and for said State, in person and all signing said document. Dated this 27 date of May 2010.

Witness my hand and official seal.

Cecilia Lopresti

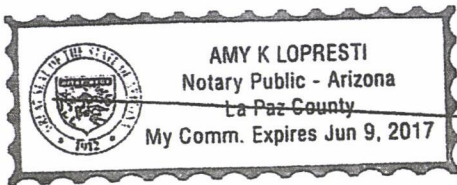

copy

CERTIFIED MAIL



Dwayne Farmer
49629 Emerald Ave., Rnbw Acre
PO Box 5335
Quartzsite, AZ 85359



7015 1520 0000 1666 2701

UNITED STATES
DEPARTMENT OF THE INTERIOR
Bureau of Land Management
Arizona State Office
One North Central Avenue, Suite 800
Phoenix, Arizona 85004-4427



1022



85004

U.S. POSTAGE
PAID
QUARTZSITE, AZ
85346
JUL 29, 16
AMOUNT
\$5.12
R2304Y122752-01

RECEIVED
BLM AZ STATE OFFICE
2016 AUG - 2 A 8 39

3800 (9200) RM

AMC 427687
AMC

44984

850044427 0041



Dwayne Farmer

49629 Emerald Ave., Rnbw Acre

PO Box 5335

Quartzsite, AZ 85359



Dwayne Farmer

49629 Emerald Ave., Rnbw Acre

PO Box 5335

Quartzsite, AZ 85359



Dwayne Farmer

49629 Emerald Ave., Rnbw Acre

PO Box 5335

Quartzsite, AZ 85359





United States Department of the Interior



BUREAU OF LAND MANAGEMENT

Arizona State Office

One North Central Avenue, Suite 800

Phoenix, Arizona 85004-4427

www.blm.gov/az/

JUN 15 2016

In Reply Refer To:

3800 (9200) IO

AMC427687; AMC436649

CERTIFIED MAIL – RETURN RECEIPT REQUESTED 7016 0340 0000 2481 6460

NOTICE

DWAYNE FARMER

JOYCE FARMER

PO BOX 5335

QUARTZSITE, AZ 85359

:
:
:

This Decision Affects Those Claims
Shown in the Block Below.

AMC427687; AMC436649

HIDDEN TREASURE; BIG WASH

Transfer(s) Not Processed

A conveyance document to transfer ownership of the mining claim(s) listed above was received by the Bureau of Land Management (BLM) Arizona State Office. The transfer(s) of ownership cannot be processed for the following reason(s):



We received your request to process two Quitclaim Deeds; however, no money was submitted with your documents. The processing fee for a transfer of interest is \$10 per claim, per each grantee. A fee of \$20 is required to complete the transfer of interests.

If appropriate, please submit a corrected conveyance document, required documents, or additional fees, within 30 days of your receipt of this notice. If the required information is not received within the 30-day timeframe, no further action will be taken, and the BLM will retain the non-refundable processing fees submitted.

If additional information is required, please contact Iran Ortega at 602-417-9355. Please include your AMC serial number(s) on all correspondence.

Rebecca Heick
Deputy State Director
Lands, Minerals and Energy Division

SENDER: COMPLETE THIS SECTION	COMPLETE THIS SECTION ON DELIVERY
<ul style="list-style-type: none"> ■ Complete items 1, 2, and 3. ■ Print your name and address on the reverse so that we can return the card to you. ■ Attach this card to the back of the mailpiece, or on the front if space permits. 	<p>A. Signature <input type="checkbox"/> Agent <input checked="" type="checkbox"/> Addressee <i>Wayne Farmer</i></p>
<p>1. Article Addressed to:</p> <p>DWAYNE FARMER JOYCE FARMER PO BOX 5335 QUARTZSITE AZ 85359 920/IO/AMC427687; AMC436649</p>	<p>B. Received by (Printed Name) <i>Wayne Farmer</i> C. Date of Delivery <i>6/20/16</i></p> <p>D. Is delivery address different from Item 1? <input type="checkbox"/> Yes If YES, enter delivery address below: <input type="checkbox"/> No</p>
 9590 9402 1279 5246 0900 16	<p>3. Service Type</p> <p><input type="checkbox"/> Adult Signature <input type="checkbox"/> Priority Mail Express® <input type="checkbox"/> Adult Signature Restricted Delivery <input type="checkbox"/> Registered Mail™ <input checked="" type="checkbox"/> Certified Mail® <input type="checkbox"/> Registered Mail Restricted Delivery <input type="checkbox"/> Certified Mail Restricted Delivery <input checked="" type="checkbox"/> Return Receipt for Merchandise <input type="checkbox"/> Collect on Delivery <input checked="" type="checkbox"/> Signature Confirmation™ <input type="checkbox"/> Collect on Delivery Restricted Delivery <input type="checkbox"/> Signature Confirmation Restricted Delivery</p> <p><input type="checkbox"/> Restricted Delivery</p>
<p>2. Article Number (Transfer from service label)</p> <p>7016 0340 0000 2481 6460</p>	<p>PS Form 3811, July 2015 PSN 7530-02-000-9053 Domestic Return Receipt</p>

<p>USPS TRACKING#</p>  9590 9402 1279 5246 0900 16		<p>First-Class Mail Postage & Fees Paid USPS Permit No. G-10</p>
<p>United States Postal Service</p> <p>RECEIVED BLM AZ STATE OFFICE</p> <p>2016 JUN 22 P 1:52 PHOENIX, ARIZONA</p>	<p>Sender: Please print your name, address, and ZIP+4® in this box*</p> <p>UNITED STATES DEPARTMENT OF THE INTERIOR Bureau of Land Management Arizona State Office One N. Central Avenue, Suite 800 Phoenix, AZ 85004-4427</p>	

NOTICE!!

These documents have been scanned!

Do not place un-scanned documents beneath this notice!

Do not remove this notice from this file!

GPO Jacket No. 560-102
Print Order 61540
Rise Business Services, LLC
Job=AZ15 5/6/2019



Box Number= AZ15020



Claim Begin-End: AMC436649-AMC436649

3 Transfers



AZ15020-18

AMC435945-AMC436659

**NO
DOCUMENTS
FOUND**

NO DOCUMENTS FOUND
NO DOCUMENTS FOUND

NOTICE!!

These documents have been scanned!

Do not place un-scanned documents beneath this notice!

Do not remove this notice from this file!

GPO Jacket No. 560-102
Print Order 61540
Rise Business Services, LLC
Job=AZ15 5/6/2019



Box Number= AZ15020



Claim Begin-End: AMC436649-AMC436649

4 Annual Filings



AZ15020-18

AMC435945-AMC436659

Run Date: 07/23/18

Run Time: 04:31 PM

**DEPARTMENT OF THE INTERIOR
BUREAU OF LAND MANAGEMENT
MINING CLAIMS**

MC Maintenance Fees Paid Through the BLM Pay Portal

CBS Receipt: 4206754

Printed For Lead File # AMC436649

Agency Tracking ID: 1530886924

Assessment Year: 2019

Number of BLM Serial Nr: 2

Paid On: 07/06/2018

Total Amount Paid: \$310.00

Claim Name	BLM Serial No	Lead File No	Amount Paid
BIG WASH	AMC436649	AMC436649	\$155.00
MEDICINE WHEEL	AMC450563	AMC450563	\$155.00

United States Department of the Interior
Bureau of Land Management
 BUSINESS & SUPPORT SVCS DIV
 ONE N CENTRAL AVE SUITE 800
 PHOENIX, AZ 85004 -4427
 Phone: 602-417-9200

Receipt

No: 4206754

Transaction #: 4321727	
Date of Transaction: 07/06/2018	
CUSTOMER:	
DWAYNE FARMER 49629 EMERALD AVE QUARTZSITE,AZ 85359 US	

LINE #	QTY	DESCRIPTION	REMARKS	UNIT PRICE	TOTAL
1	1.00	LOCATABLE MINERALS / MINING CLAIMS- NOT NEW-UNADJUD,ONE AUTH NO. ONLY / MINING CLAIM MONEY RECEIVED CASES: AMC436649/\$310.00		- n/a -	310.00
TOTAL:					\$310.00

PAYMENT INFORMATION			
NOTE: Items will appear on credit card statement as "BLM O Mining Claim".			
1	AMOUNT:	310.00	POSTMARKED: N/A
	TYPE:	CREDIT CARD	RECEIVED: 07/06/2018
	NAME:	DWAYNE FARMER 49629 EMERALD AVE QUARTZSITE AZ 85359 US	
	CARD NO:	XXXXXXXXXXXX1145	AUTH CODE: 098722
	NAME ON CARD:	DWAYNE FARMER	
	SIGNATURE:		

REMARKS

This receipt was generated by the automated BLM Collections and Billing System and is a paper representation of a portion of the official electronic record contained therein.

Run Date: 07/20/17

Run Time: 10:48 AM

**DEPARTMENT OF THE INTERIOR
BUREAU OF LAND MANAGEMENT
MINING CLAIMS**

MC Maintenance Fees Paid Through the BLM Pay Portal

CBS Receipt: 3888619

Printed For Lead File # AMC436649

Agency Tracking ID: 1499979291

Assessment Year: 2018

Number of BLM Serial Nr: 1

Paid On: 07/13/2017

Total Amount Paid: \$155.00

Claim Name	BLM Serial No	Lead File No	Amount Paid
BIG WASH	AMC436649	AMC436649	\$155.00

United States Department of the Interior
Bureau of Land Management
 BUSINESS & SUPPORT SVCS DIV
 ONE N CENTRAL AVE SUITE 800
 PHOENIX, AZ 85004 -4427
 Phone: 602-417-9200

Receipt

No: 3888619

Transaction #: 3997836	
Date of Transaction: 07/13/2017	
CUSTOMER:	
DWAYBE D FARNER DWAYNE FARMER BOX 5335 QUARTZSITE, AZ 85359 US	

LINE #	QTY	DESCRIPTION	REMARKS	UNIT PRICE	TOTAL
1	1.00	LOCATABLE MINERALS / MINING CLAIMS- NOT NEW-UNADJUD.ONE AUTH NO. ONLY / MINING CLAIM MONEY RECEIVED CASES: AMC436649/\$155.00		- n/a -	155.00
TOTAL:					\$155.00

PAYMENT INFORMATION			
NOTE: Items will appear on credit card statement as "BLM O Mining Claim".			
1	AMOUNT:	155.00	POSTMARKED: N/A
	TYPE:	CREDIT CARD	RECEIVED: 07/13/2017
	NAME:	DWAYBE D FARNER DWAYNE FARMER BOX 5335 QUARTZSITE AZ 85359 US	
	CARD NO:	XXXXXXXXXXXX3406	AUTH CODE: 013761
	NAME ON CARD:	DWAYBE D FARNER	
	EXPIRES:	08/2020	
	SIGNATURE:		

REMARKS

This receipt was generated by the automated BLM Collections and Billing System and is a paper representation of a portion of the official electronic record contained therein.

427687
436649

United States Department of the Interior
Bureau of Land Management
 DIV OF LANDS, MINRLS & ENERGY
 ONE N CENTRAL AVE
 PHOENIX, AZ 85004 -4427
 Phone: 602-417-9200

Receipt

No: 3628619

Transaction #: 3732384	
Date of Transaction: 08/12/2016	
CUSTOMER:	
NUGGET WRANGLERS ASSOCIATION PO BOX 5335 QUARTZSITE, AZ 85359-5335 US	

LINE #	QTY	DESCRIPTION	REMARKS	UNIT PRICE	TOTAL
1	1.00	LOCATABLE MINERALS / MINING CLAIMS- NOT NEW-UNADJUD, ONE AUTH NO. ONLY / MINING CLAIM MONEY RECEIVED CASES: AMC427687/\$20.00	AMENDMENT - 2	- n/a -	20.00
2	1.00	LOCATABLE MINERALS / MINING CLAIMS- NOT NEW-UNADJUD, ONE AUTH NO. ONLY / MINING CLAIM MONEY RECEIVED CASES: AMC427687/\$310.00	MAINT FEE 2017 - 2	- n/a -	310.00
TOTAL:					\$330.00

PAYMENT INFORMATION			
1	AMOUNT:	155.00	POSTMARKED: 08/09/2016
	TYPE:	CHECK	RECEIVED: 08/11/2016
	CHECK NO:	1217	
	NAME:	NUGGET WRANGLERS ASSOCIATION PO BOX 5335 QUARTZSITE AZ 85359-5335 US	
2	AMOUNT:	155.00	POSTMARKED: 08/09/2016
	TYPE:	CHECK	RECEIVED: 08/11/2016
	CHECK NO:	1218	
	NAME:	NUGGET WRANGLERS ASSOCIATION PO BOX 5335 QUARTZSITE AZ 85359-5335 US	
3	AMOUNT:	20.00	POSTMARKED: 08/09/2016
	TYPE:	CHECK	RECEIVED: 08/11/2016
	CHECK NO:	1219	

AUG 15 2016
MAINT FEE
RAM

NAME:	NUGGET WRANGLERS ASSOCIATION PO BOX 5335 QUARTZSITE AZ 85359-5335 US
-------	--

REMARKS

This receipt was generated by the automated BLM Collections and Billing System and is a paper representation of a portion of the official electronic record contained therein.

NOTICE!!

These documents have been scanned!

Do not place un-scanned documents beneath this notice!

Do not remove this notice from this file!

GPO Jacket No. 560-102
Print Order 61540
Rise Business Services, LLC
Job=AZ15 5/6/2019



Box Number= AZ15020



Claim Begin-End: AMC436649-AMC436649

5 Miscellaneous



AZ15020-18

AMC435945-AMC436659

Amc436649

Authorized Date08/22/2016

Instructions to Accounts AZ BLM REFUND \$11, TO DWAYNE FARMER, FOR OVERPAYMENT
OF FEES, ON AMC436649, RECEIPT #3487365. RM

Login ID6222

Entry Date08/22/2016

Total Amount\$11.00

United States Department of the Interior
Bureau of Land Management
 DIV OF LANDS, MINRLS & ENERGY
 ONE N CENTRAL AVE
 PHOENIX, AZ 85004 -4427
 Phone: 602-417-9200

Receipt **AMC436649**

No: 3628619

Transaction #: 3732384	
Date of Transaction: 08/12/2016	
CUSTOMER:	
NUGGET WRANGLERS ASSOCIATION PO BOX 5335 QUARTZSITE, AZ 85359-5335 US	

LINE #	QTY	DESCRIPTION	REMARKS	UNIT PRICE	TOTAL
1	1.00	LOCATABLE MINERALS / MINING CLAIMS- NOT NEW-UNADJUD, ONE AUTH NO. ONLY / MINING CLAIM MONEY RECEIVED CASES: AMC427687/\$20.00	AMENDMENT - 2	- n/a -	20.00
2	1.00	LOCATABLE MINERALS / MINING CLAIMS- NOT NEW-UNADJUD, ONE AUTH NO. ONLY / MINING CLAIM MONEY RECEIVED CASES: AMC427687/\$310.00	MAINT FEE 2017 - 2	- n/a -	310.00
TOTAL:					\$330.00

PAYMENT INFORMATION					
1	AMOUNT:	155.00	POSTMARKED:	08/09/2016	
	TYPE:	CHECK	RECEIVED:	08/11/2016	
	CHECK NO:	1217			
	NAME:	NUGGET WRANGLERS ASSOCIATION PO BOX 5335 QUARTZSITE AZ 85359-5335 US			
2	AMOUNT:	155.00	POSTMARKED:	08/09/2016	
	TYPE:	CHECK	RECEIVED:	08/11/2016	
	CHECK NO:	1218			
	NAME:	NUGGET WRANGLERS ASSOCIATION PO BOX 5335 QUARTZSITE AZ 85359-5335 US			
3	AMOUNT:	20.00	POSTMARKED:	08/09/2016	
	TYPE:	CHECK	RECEIVED:	08/11/2016	
	CHECK NO:	1219			
	NAME:	NUGGET WRANGLERS ASSOCIATION PO BOX 5335 QUARTZSITE AZ 85359-5335 US			

ENTERED
 635
AUG 16 2016
 BY: *[Signature]*

AUG 15 2016
 MAINT FEE
 RAN

AMENDMENT ON AMC436649
 IRS LTR DTD 7/25/2016.

NAME:	NUGGET WRANGLERS ASSOCIATION PO BOX 5335 QUARTZSITE AZ 85359-5335 US
-------	--

REMARKS

This receipt was generated by the automated BLM Collections and Billing System and is a paper representation of a portion of the official electronic record contained therein.

NOTICE!!

These documents have been scanned!

Do not place un-scanned documents beneath this notice!

Do not remove this notice from this file!

GPO Jacket No. 560-102
Print Order 61540
Rise Business Services, LLC
Job=AZ15 5/6/2019



Box Number= AZ15020



Claim Begin-End: AMC436649-AMC436649

6 Location Notices-Amendments and Supporting Documents



AZ15020-18

AMC435945-AMC436659

MINING CLAIM STATUS REPORT

Data Entered: 02/09/16 Ram

MTP Checked By: 02/09/16 Ram
GEO Checked By: 02/09/16 Ram

LEAD SERIAL NUMBER: AMC 436649 thru AMC _____

NUMBER OF CLAIMS & TYPE:

LODE

PLACER
1
ASSOCIATION PLACER

MILL SITE

TUNNEL SITE

CHARGES:

Location Fee @ \$37 = \$ 37.00
Processing Fee @ \$20 = \$ 20.00
Maintenance Fee @ \$155 = \$ 155.00
Add'l Maint Fee for Assoc Placer = \$ 155.00
SUBTOTAL \$ 3107.00
Overpayment Other Fees \$ 11.00
Other Fees \$ _____
TOTAL \$ 378.00

TOTAL ACREAGE: 40 Per Claim
(Placer Only)

NUMBER OF LOCATORS: 2

DOCUMENTS RECEIVED VIA : Over-the-Counter [] Mail [] **TIMELY FILED:** Yes [] No []

LEGAL DESCRIPTION: T 4N R 20W SEC 11, 12, 13, 14
T _____ R _____ SEC _____
T _____ R _____ SEC _____
T _____ R _____ SEC _____
T _____ R _____ SEC _____

BLM [] FOREST SERVICE [] _____ SUBJ TO PL 359: Yes [] No []
WILDERNESS AREA [] _____

SPLIT ESTATE: N/A [] SX [] PX [] OTHER [] _____
SRHA [] Was proper Notice filed if located on SHRA Land? Yes [] No []

RECONVEYED MINERALS ON BLM LAND REQUIRE OPENING ORDER FROM 1944 TO 1993:

Open to Entry On _____ N/A []

COMMENTS/STATUS: VOID [] PARTIALLY VOID [] PVT MINERALS [] WITHDRAWN LANDS []
OTHER [] USED MAP FOR ULD. WRITTEN DESCRIPTION ON PGI OF NOTICE
IS INCORRECT. FM

AMC436649

[] Claimant acknowledges that portions of the following claim(s) site(s) may be void or voidable.

Printed Name of Claimant _____ Signature of Claimant _____

*****FINAL ADJUDICATION*****

DATE 6/17/2016 INITIALS RM

AMENDMENT
AMC 436649

LOCATION NOTICE FOR PLACER MINING CLAIM

NOTICE IS HEREBY GIVEN that the Big Wash
placer mining claim has been located by
Maggot Wrangler Assoc. whose current mailing
address is Box 5335
Quartzsite AZ, 85359

RECEIVED
BLM AZ STATE OFFICE
2016 AUG 11 PM 3:21
PHOENIX, ARIZONA
BLM
Date
Stamp

The general course of this claim is N to S - E to W and it is situated in
La Paz County, Arizona.

This claim is 1320 feet in length and 660 feet in width. This claim runs from the
location monument on which this location notice is posted approximately 1320 feet in a West
direction to the West end line and 660 feet in a North direction to the North end line.
This claim is marked by four monuments, one at each corner of the claim.

The location monument on which this notice is posted is situated within Section 14, Township
4 N, Range 20 W, Gila Salt River Base and Meridian, Arizona. This claim encompasses
portions of the following legal subdivision(s) if located by legal subdivision or the following quarter section (s),
section (s), Township (s) and Range (s) NE 1/4 of NE 1/4 Sec 14, NW 1/4
of NW 1/4 Sec 13, Gila Salt River Base and Meridian, Arizona.

The locality of this claim with reference to some natural object or permanent monument and additional
information (if any) concerning its locality are as follows: 3/4 mile NE Old Man
Mountain

DATED AND POSTED on the ground this 9th day of Dec, 20 15
LOCATOR(S) Dwayne Farmer

Form MCF102
Revised July 2005

This form is available from the Arizona Department of Mines & Mineral Resources and may be

AMC 436649

MINING CLAIM MAP

1 mile

Lode () Placer (X)

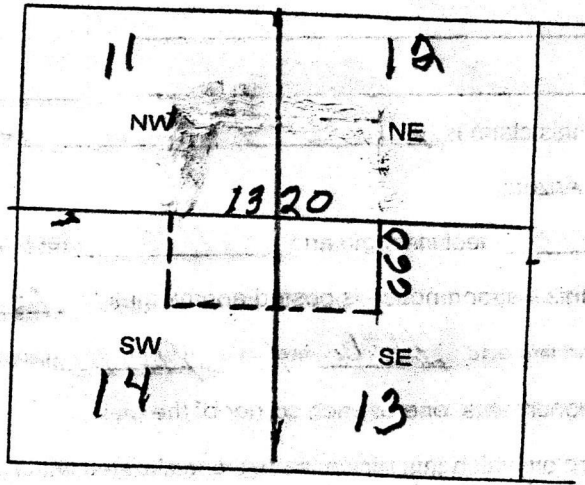

RECEIVED
 BLM AZ STATE OFFICE
 PHOENIX, ARIZONA
 2016 AUG 11 PM 3:21

Scale 1" = 2000 feet

1. The above map depicts the Big Wash mining claim, which is located in Section (s) 13, 14, Township 4 N, Range 80 W, Gila and Salt River Base and Meridian, _____ County, Arizona.

2. The type of corner and location monuments used are as follows: 4x4 Posts

3. The bearings and distances in degrees and feet between claim corners are as depicted on the map.

Form MCF100a
 Revised July 2005

This form is available from the Arizona Department of Mines & Mineral Resources and may be reproduced.

D. J. Garval

2015-04503
Page 1 of 1
Requested by: Dwayne Farmer
SHELLY D BAKER, RECORDER
OFFICIAL RECORDS OF LA PAZ COUNTY, AZ
12-15-2015 08:45 AM Recording Fee \$10.00

LOCATION NOTICE FOR PLACER MINING CLAIM

NOTICE IS HEREBY GIVEN that the BIG WASH
_____ placer mining claim has been located by
DWAYNE FARMER whose current mailing
& JOYCE
address is PO Box 5335 QUARTZSITE, AZ
85359

BLM
Date
Stamp
RECEIVED
2016 FEB - 3 P 2:54
PHOENIX, ARIZONA
OFFICE

The general course of this claim is NORTH TO SOUTH & EAST TO WEST and it is situated in
LA PAZ County, Arizona.

This claim is 1320 feet in length and 1320 feet in width. This claim runs from the
location monument on which this location notice is posted approximately 660 feet in a NORTHERLY
direction to the NORTH end line and 660 feet in a SOUTHERLY direction to the SOUTH end line.

This claim is marked by four monuments, one at each corner of the claim.

The location monument on which this notice is posted is situated within Section 11, 12, 13, 14 Township
4 N, Range 20 W, Gila Salt River Base and Meridian, Arizona. This claim encompasses
portions of the following legal subdivision(s) if located by legal subdivision or the following quarter section (s),
section (s), Township (s) and Range (s) NW 1/4 OF NW 1/4 OF SEC 11, NE 1/4 OF NE 1/4 OF SEC 12
SW 1/4 OF SW 1/4 OF SEC 11, SE 1/4 OF SE 1/4 OF SEC 13, Gila Salt River Base and Meridian, Arizona.

The locality of this claim with reference to some natural object or permanent monument and additional
information (if any) concerning its locality are as follows: 3/4 MILE NE OF OLDMAN MOUNTAIN

ANCL 436649

DATED AND POSTED on the ground this 9TH day of DECEMBER, 2015

LOCATOR(S) DWAYNE FARMER *Dwayne Farmer*
JOYCE FARMER *Joyce Farmer*

Form MCF102
Revised July 2005

MINING CLAIM MAP

Lode () Placer (X)

1/4 mile

1 MILE

20 ACRES } SE 1/4 OF SE 1/4 SEC 11
 SW 1/4 OF SW 1/4 SEC 12

20 ACRES } NE 1/4 OF NE 1/4 SEC 14
 NW 1/4 OF NW 1/4 SEC 13

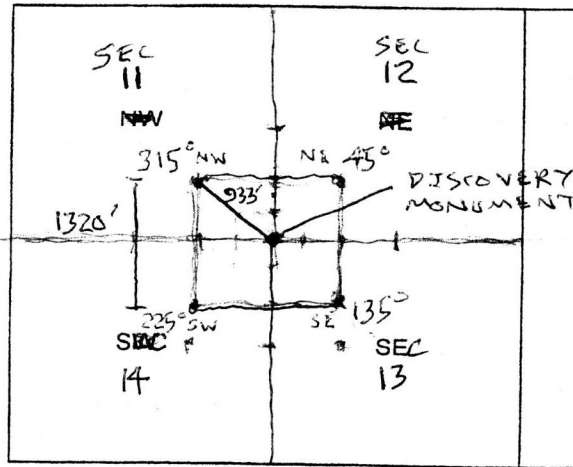

RECEIVED
 PLM A & S OFFICE
 2016 FEB - 3 P 2: 54
 PHOENIX, ARIZONA

AMC436649

Scale 1" = 2000 feet



1. The above map depicts the BIG WASH mining claim, which is located in Section (s) 11, 12, 13, 14, Township 4 N, Range 20 W, Gila and Salt River Base and Meridian, LA PAZ County, Arizona.

2. The type of corner and location monuments used are as follows: 4x4 POSTS
NW COR IS 933 FEET NW OF DISCOVERY MONUMENT

3. The bearings and distances in degrees and feet between claim corners are as depicted on the map.

Form MCF100a
 Revised July 2005

DEPARTMENT OF INTERIOR
BUREAU OF LAND MANAGEMENT

Input Parameters for Geographic Report with Land

System Id = CR

Admin State = AZ

Geo State =

Casetype Begins With

Case Disp Txt = AUTHORIZED, CANCELLED, EXPIRED, PENDING, REJECTED, RELINQUISHED, WITHDRAWN

Mer Twp Rng =

Section =

Mtrs = 14 0040N 0200W 011, 14 0040N 0200W 999

Commodity =

Commodity Txt =

Pending Org =

Pend Org Decode =

Total Rows Returned: 0

